

# OAKLEAF COMMERCE CENTER

## A FLEX/LIGHT INDUSTRIAL DEVELOPMENT IN THE COMMUNITY OF OAKLEAF

- Under development in Clay County, FL southwest of the city of Jacksonville
- Located on 16 acres
- Up to 142,950 square feet across three buildings and a pad site
  - Phase 1: Three buildings
  - Phase 2: 20,000 SF build-to-suit opportunity
- 20' clear heights
- Dock loaded and at-grade drive-ins available
- Leasable spaces starting at 2,250 and 2,700 square feet
- Ample free parking
- Positioned off First Coast Expressway with easy connections to I-10 and I-95
- Located within the robust residential and retail community of Oakleaf
- Building signage opportunities
- Customize space with our in-house design and construction team



[Merritt-Oakleaf.com](http://Merritt-Oakleaf.com)



# CONCEPTUAL SITE PLAN

3840, 3830 & 3810 Integrity Way

## BUILDING

3840 Integrity Way  
3830 Integrity Way  
3810 Integrity Way

## TOTAL SF

32,250 SF  
51,300 SF  
59,400 SF

## TOTAL PARK

142,950 SF



## SAMPLE FLOORPLAN 3,000 SF

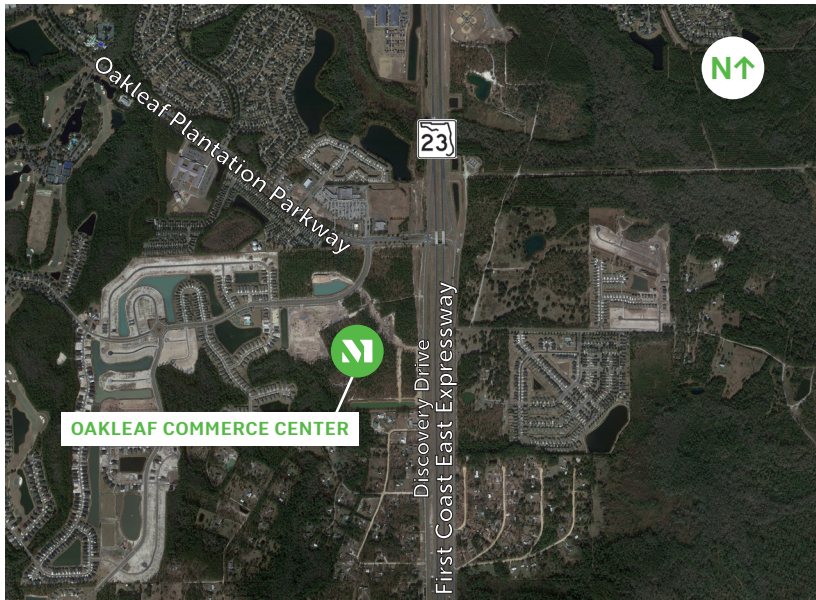
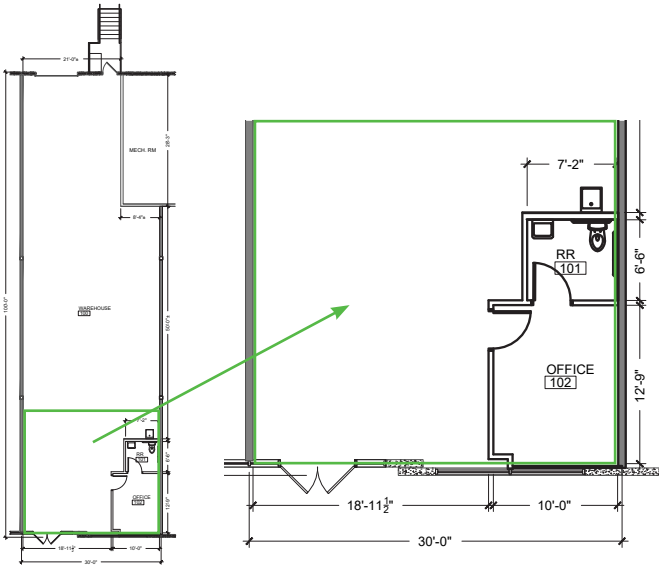

For additional information, contact:

Pat Franklin | pfranklin@merrittproperties.com | 904.515.2030  
Remy Merritt | remym@merrittproperties.com | 443.983.6296

**Merritt-Oakleaf.com**

