

- KEY:**
- = CMU Partition
 - = Existing Partition
 - = New Partition
 - = Low Partition
 - = Demolished Partition
 - = Outlet Loc. Approx.
 - 00 = Ceiling Heights
 - 00 = Door Heights

STANDARD SPECIFICATIONS:

Partition- Free standing partitions to be 1/2" sheet rock over 3 5/8" metal stud with fiberglass insulation.

Mason walls - Existing to remain as is or furred out with 1 5/8" metal stud and 1/2" drywall when indicated on plan.

Doors- Existing doors shall remain U.O.N. (minimum door size shall be 3'x6'-8")

Ceiling - Existing suspended acoustical tile and light fixtures to remain U.O.N.

Electric- Existing to remain U.O.N. Standard private offices have 3 duplex outlets.

Millwork - Existing work surfaces and pantry millwork to remain U.O.N. Standard millwork material is plastic laminate.

Finishes- Existing finishes shall remain U.O.N. Standard wall paint is (typically) 2 coats of satin latex .

Special conditions at tenants cost not limited to upgrades & specialty HVAC

GENERAL NOTES:

Merritt is not responsible for providing or installing appliances, phones, computer wiring, furniture and/or custom built-ins unless specified. Floor plan may be field adjusted due to existing conditions not shown on plan.

PROSPECT TENANT
 03.10.2022
 SUITE 220
 2,811 RSF

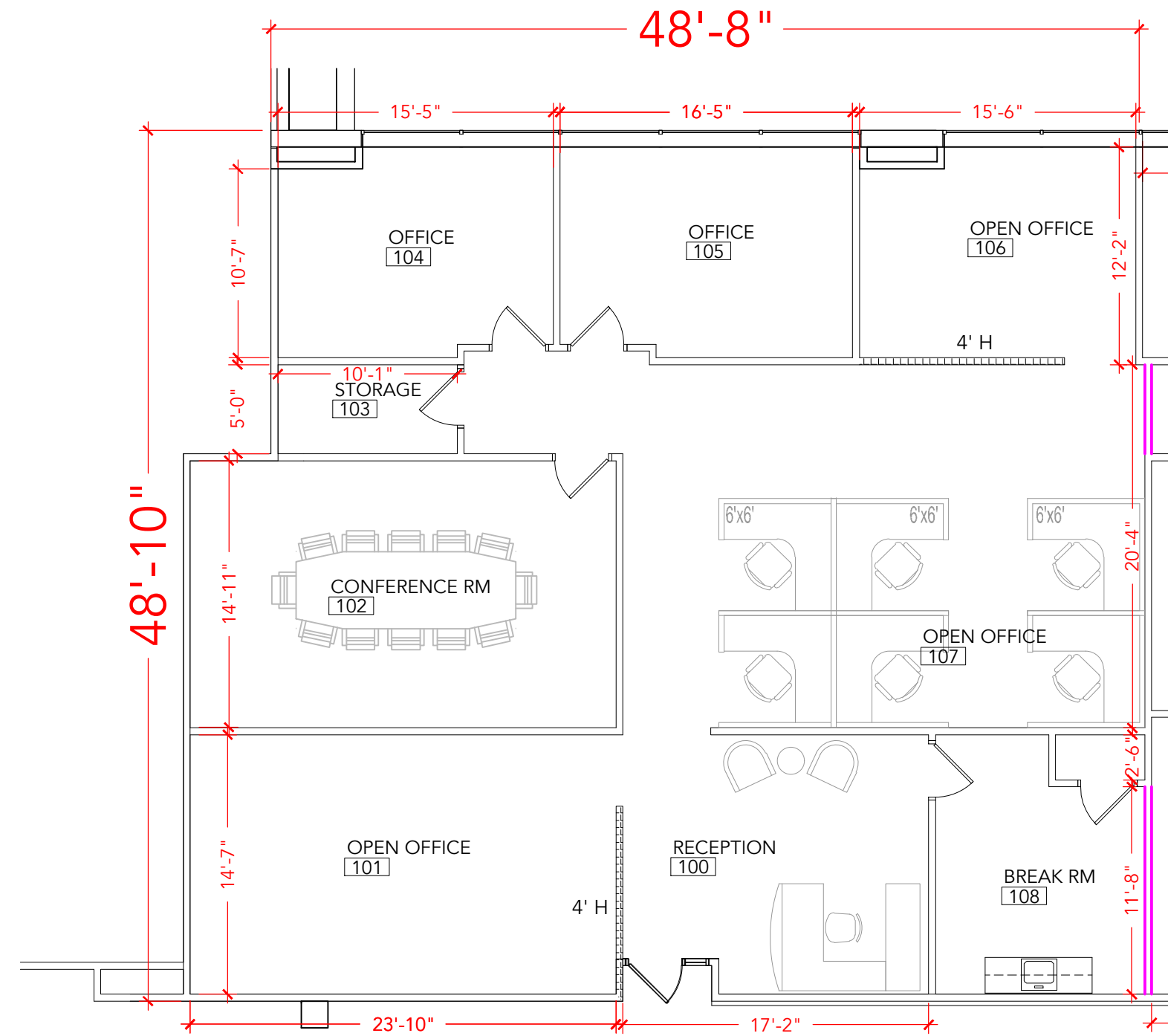

1 NEW CONSTRUCTION PLAN
 1/8" = 1'-0"

ASHBROOK
 20098 ASHBROOK PLACE
 ASHBURN, VA 20147
 SUITE 220

DATE	REV	DESCRIPTION	INITIALS

PROJECT NO:
 AB4-220

DRAWN BY:
 TD

SCALE:
 1/8" = 1'

TITLE:
 SPACE PLAN

