

- KEY:**
- = CMU Partition
  - = Existing Partition
  - = New Partition
  - = Low Partition
  - = Demolished Partition
  - = Outlet Loc. Approx.
  - 00 = Ceiling Heights
  - 00 = Door Heights

**STANDARD SPECIFICATIONS:**

Partition- Free standing partitions to be 1/2" sheet rock over 3 5/8" metal stud with fiberglass insulation.

Mason walls - Existing to remain as is or furred out with 1 5/8" metal stud and 1/2" drywall when indicated on plan.

Doors- Existing doors shall remain U.O.N. (minimum door size shall be 3'x6'-8" )

Ceiling - Existing suspended acoustical tile and light fixtures to remain U.O.N.

Electric - Existing to remain U.O.N. Standard private offices have 3 duplex outlets.

Millwork - Existing work surfaces and pantry millwork to remain U.O.N. Standard millwork material is plastic laminate.

Finishes- Existing finishes shall remain U.O.N. Standard wall paint is (typically) 2 coats of satin latex .

Special conditions at tenants cost not limited to upgrades & specialty HVAC

**GENERAL NOTES:**

Merritt is not responsible for providing or installing appliances, phones, computer wiring, furniture and/or custom built-ins unless specified. Floor plan may be field adjusted due to existing conditions not shown on plan.

**PROSPECT TENANT**  
 03.10.2022  
 SUITE 230  
 2,670 RSF

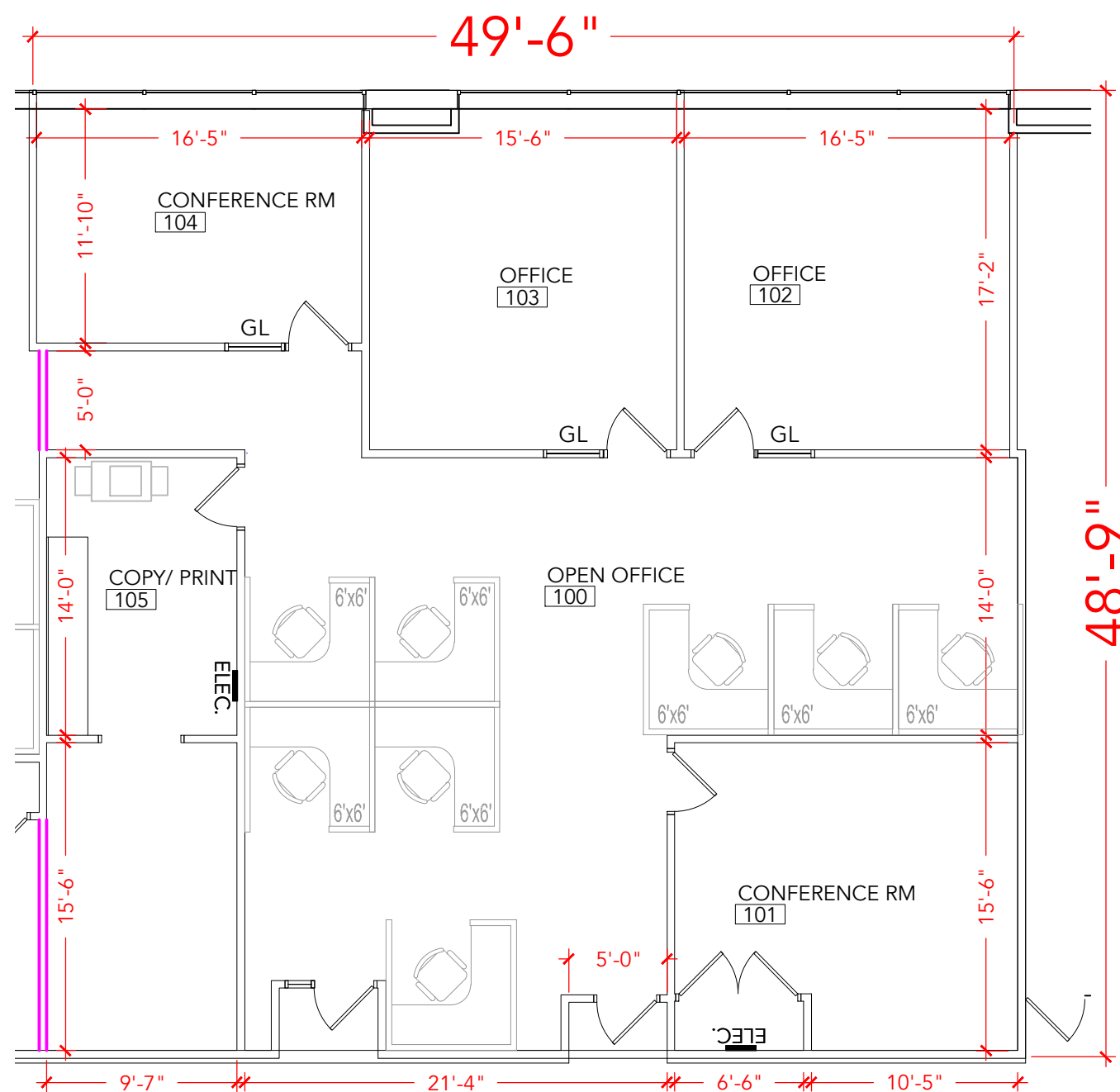

1 **NEW CONSTRUCTION PLAN**  
 1/8" = 1'-0"

**ASHBROOK**  
 20098 ASHBROOK PLACE  
 ASHBURN, VA 20147  
 SUITE 230

DATE BID	REV	DATE	DESCRIPTION	INI

PROJECT NO:  
 AB4-220

DRAWN BY:  
 TD

SCALE:  
 1/8" = 1'

TITLE:  
 SPACE PLAN

