

**SPEC**  
**06.09.25 (HLG)**  
 2,134 OFFICE RSF  
 9,541 WAREHOUSE RSF  
 11,675 TOTAL RSF (% MECH RM)

- KEY:**
- ▨ = CMU Partition
  - ▬ = Existing Partition
  - ▬ (magenta) = New Partition
  - ▨ (magenta) = Low Partition
  - ▬ (blue dashed) = Demolished Partition
  - = Outlet Loc. Approx.
  - 00 = Ceiling Heights
  - 00 = Door Heights

**STANDARD SPECIFICATIONS:**

Partition- Free standing partions to be 1/2" sheet rock over 3 5/8" metal stud with fiberglass insulation.  
 Mason walls - Existing to remain as is or furred out with 1 5/8" metal stud and 1/2" drywall when indicated on plan.  
 Doors- Existing doors shall remain U.O.N. (minimum door size shall be 3'x6'-8" )  
 Ceiling - Existing suspended acoustical tile and light fixtures to remain U.O.N.  
 Electric- Existing to remain U.O.N. Standard private offices have 3 duplex outlets.  
 Millwork - Existing work surfaces and pantry millwork to remain U.O.N.  
 Standard millwork material is plastic laminate.  
 Finishes- Existing finishes shall remain U.O.N. Standard wall paint is (typically) 2 coats of satin latex .  
 Special conditions at tenants cost not limited to upgrades & specialty HVAC

**GENERAL NOTES:**

Merritt is not responsible for providing or installing appliances, phones, computer wiring, furniture and/or custom built-ins unless specified. Floor plan may be field adjusted due to existing conditions not shown on plan.

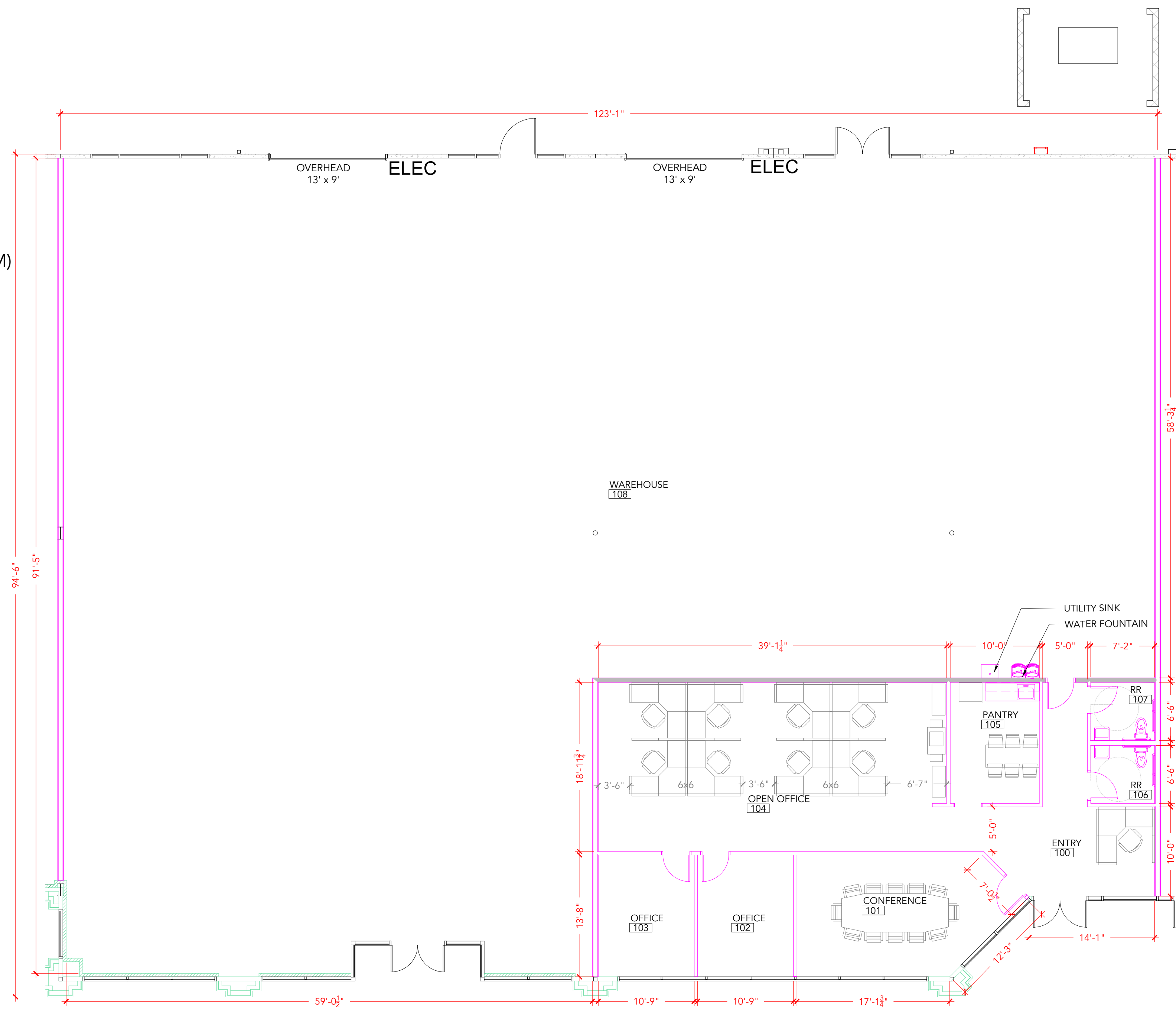

**GATE PARKWAY**  
 5022 GATE PARKWAY,  
 JACKSONVILLE FL 32256  
 SUITE 304-306

DATE BID -

REV	DATE	DESCRIPTION	INT

PROJECT NO:  
**JAGP3-304-306**  
 DRAWN BY: XX AS-BUILT DATE:  
 NEEDS TO BE FIELD VERIFIED  
 SCALE: 1/8" = 1'  
 TITLE: SPACE PLAN

